

NPT Valves & Fittings

Pipe Connection NPT Needle Valves

(Up to 15,000 PSI / 1034 BAR)

Specifications

Pressure rating	: Up to 15,000 psi
Temp. Rating	: -100°F to 600°F
Body Material	: SS316 cold Worked
Stem	: 15-5 PH
Packing	: Glass filled Teflon

Typical Applications

- Hydraulic applications
- Pneumatic applications
- General plant service
- Isolating or venting

Optional

- Grafoil Packing for temperature up to 800°F
- Extended Stuffing Box for temperature up to 1200°F
- Air Actuator for remote control operation is available
- Can be manufactured to meet NACE MR0175 standard
- Quick Open Needle Valve
 - o Fully open in 1-3/4 turn
 - o Reduces throttling and therefore increase seat life

Features & Benefits

HTG Standard Pipe Needle Valve offer low-torque, fully open in 3-1/2 turn and compact design providing positive shutoff in applications up to 15,000 psi. Other features include:

- Two pieces heavy duty non-rotating stem for a reliable assembly.
- Bi-directional flow capability.
- Panel mounting option available.
- 4-sided tapered stem for maximum handle contact
- Complete material traceability.

Quick Open Needle Valve

(Up to 15,000 PSI / 1034 BAR)

Same features as the standard needle valve with the exception of:

- Valve is fully open or closed in as little as 1.75 turns, the first in high pressure industry!
- Stem is lifted off of the seat >2X faster than conventional valves, which increases seat life.
- Valve is closed 2x faster for quicker isolation.
- Less than half the number of turns to fully open compared to competitor's valves. Less operator fatigue when opening/closing.
- Three-piece, heavy-duty, non-rotating stem .

Standard Valve

1/2" NPT Connection,
Full travel in 4.5 turns

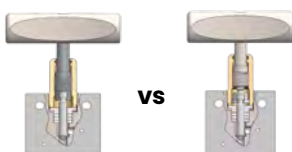

Quick Open Valve

1/2" NPT Connection,
Full travel in 2.25 turns

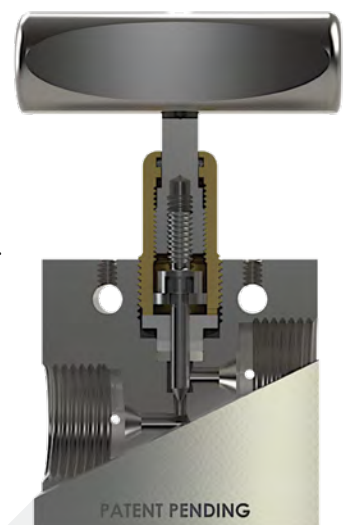

With Quick Open Valve the CV will be fully unblocked, thus allow full flow.

NPT Valves & Fittings

Pipe Connection NPT Check Valves (Up to 15,000 PSI / 1034 BAR)

Specifications

Pressure rating	: Up to 15,000 psi
Ball Seat Poppet	: -420°F to 1200°F
Soft Seat Poppet	: -65°F to 250°F
Body Material	: SS316 cold worked
Cracking Press.	: 15 PSI

Typical Applications

- Hydraulic applications
- Pneumatic applications
- General plant service

Features & Benefits

- Prevents reverse flow where leak-tight shutoff is required.
- Ball Seat Poppet offers metal to metal seat for rapid cycling or severe environments.
- Soft Seat Poppet offers O-ring seat for fast shutoff and reliable seal.
- Nitrile is standard material of Soft Seat Poppet Check Valve.
- Complete material traceability.



Pipe Connection NPT Fittings (Up to 15,000 PSI / 1034 BAR)

Specifications

Pressure rating	: Up to 15,000 psi
Body Material	: SS316 cold worked

Features & Benefits

- A complete range of elbows, tees, crosses and adaptors are available for all of the tubing connection sizes.
- Can be manufactured to meet NACE MR0175 standard.
- Other materials available on request.



NPT Standard Valves (Up to 15,000 PSI / 1034 BAR)

NPT 2-Way Straight Valves

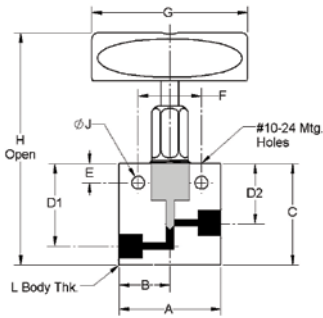

Pressure (PSI)	Connection Type	End Connection Size in.	Part Number	Orifice in. (mm)
15,000	Female NPT	1/4	15NVS4NF	0.25 (6.4)
		3/8	15NVS6NF	0.312 (7.9)
		1/2	15NVS8NF	0.312 (7.9)
10,000	Female NPT	3/4	10NVS12NF	0.438 (11.1)
		1	10NVS16NF	0.562 (14.3)

Dimensions, in. (mm)

A	B	C	D1	D2	E	F	G	H	J	L
2.00 (50.8)	1.00 (25.4)	2.00 (50.8)	1.63 (41.28)	1.19 (30.2)	0.38 (9.7)	1.24 (31.5)	3.00 (76.2)	4.84 (123.0)	0.25 (6.4)	1.00 (25.4)
2.50 (63.5)	1.25 (31.8)	2.88 (73.2)	2.38 (60.4)	1.75 (44.5)	0.50 (12.7)	1.38 (35.0)	4.00 (102.0)	5.46 (139.0)	0.34 (8.7)	1.00 (25.4)
2.50 (63.5)	1.25 (31.8)	3.00 (76.2)	2.38 (60.4)	1.75 (44.5)	0.50 (12.7)	1.38 (35.0)	4.00 (102.0)	5.58 (142.0)	0.34 (8.7)	1.25 (31.6)
3.00 (76.2)	1.50 (38.1)	3.75 (95.3)	3.00 (76.2)	2.25 (57.2)	0.62 (15.7)	1.75 (44.5)	8.07 (102.0)	5.58 (142.0)	0.44 (11.2)	1.38 (35.1)
4.12 (105)	2.06 (52.3)	4.75 (121)	3.75 (95.3)	2.82 (71.6)	1.12 (28.4)	2.5 (63.5)	10.29 (261.4)	8.96 (227.6)	0.56 (14.2)	1.75 (44.4)

NPT 2-Way Angle Valves

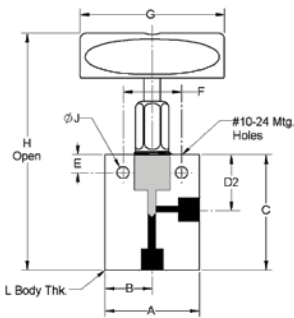

Pressure (PSI)	Connection Type	End Connection Size in.	Part Number	Orifice in. (mm)
15,000	Female NPT	1/4	15NVA4NF	0.25 (6.4)
		3/8	15NVA6NF	0.312 (7.9)
		1/2	15NVA8NF	0.312 (7.9)
10,000	Female NPT	3/4	10NVA12NF	0.44 (11.2)
		1	10NVA16NF	0.562 (14.3)

Dimensions, in. (mm)

A	B	C	D1	D2	E	F	G	H	J	L
2.00 (50.8)	1.00 (25.4)	2.44 (62.0)	-	1.19 (30.2)	0.38 (9.7)	1.24 (31.5)	3.00 (76.2)	5.28 (134.4)	0.25 (6.4)	1.00 (25.4)
2.50 (63.5)	1.25 (31.8)	3.38 (85.9)	-	1.75 (44.5)	0.50 (12.7)	1.38 (35.0)	4.00 (102.0)	5.96 (152.0)	0.34 (8.7)	1.00 (25.4)
2.50 (63.5)	1.25 (31.8)	3.38 (85.9)	-	1.75 (44.5)	0.50 (12.7)	1.38 (35.0)	4.00 (102.0)	5.96 (152.0)	0.34 (8.7)	1.25 (31.6)
3.00 (76.2)	1.5 (38.1)	4.25 (108.0)	-	2.25 (57.2)	0.62 (15.7)	1.76 (44.7)	8.07 (204)	7.56 (192.0)	0.44 (11.2)	1.38 (35.1)
4.12 (105)	2.06 (52.3)	5.13 (130.3)	-	2.82 (71.6)	1.12 (28.4)	2.5 (63.5)	10.29 (261.4)	9.45 (240.0)	0.56 (14.2)	1.75 (44.4)

NPT Standard Valves (Up to 15,000 PSI / 1034 BAR)

NPT 3-Way Valves with 2 Inlets

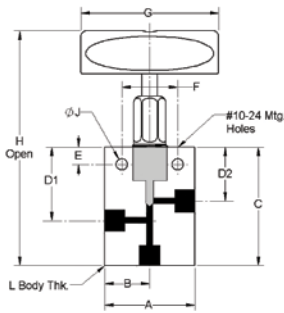

Pressure (PSI)	Connection Type	End Connection Size in.	Part Number	Orifice in. (mm)
15,000	Female NPT	1/4	15NVT2-4NF	0.25 (6.4)
		3/8	15NVT2-6NF	0.312 (7.9)
		1/2	15NVT2-8NF	0.312 (7.9)

Dimensions, in. (mm)

A	B	C	D1	D2	E	F	G	H	J	L
2.00 (50.8)	1.00 (25.4)	2.62 (66.5)	1.63 (41.3)	1.19 (30.2)	0.38 (9.7)	1.24 (31.5)	3.00 (76.2)	5.46 (139.5)	0.25 (6.4)	1.00 (25.4)
2.50 (63.5)	1.25 (31.8)	3.62 (85.9)	2.38 (60.4)	1.75 (44.5)	0.50 (12.7)	1.38 (35.0)	4.00 (102.0)	6.20 (157.5)	0.34 (8.7)	1.00 (25.4)
2.50 (63.5)	1.25 (31.8)	3.62 (85.9)	2.38 (60.4)	1.75 (44.5)	0.50 (12.7)	1.38 (35.0)	4.00 (102.0)	6.20 (157.5)	0.34 (8.7)	1.25 (31.6)

NPT 3-Way Valves with 1 Inlet

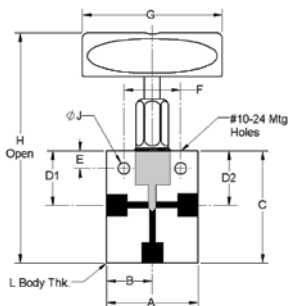

Pressure (PSI)	Connection Type	End Connection Size in.	Part Number	Orifice in. (mm)
15,000	Female NPT	1/4	15NVT1-4NF	0.25 (6.4)
		3/8	15NVT1-6NF	0.312 (7.9)
		1/2	15NVT1-8NF	0.312 (7.9)

Dimensions, in. (mm)

A	B	C	D1	D2	E	F	G	H	J	L
2.00 (50.8)	1.00 (25.4)	2.44 (62.0)	1.19 (30.2)	1.19 (30.2)	0.38 (9.7)	1.24 (31.5)	3.00 (76.2)	5.28 (134.1)	0.25 (6.4)	1.00 (25.4)
2.50 (63.5)	1.25 (31.8)	3.38 (85.9)	1.75 (44.5)	1.75 (44.5)	0.50 (12.7)	1.38 (35.0)	4.00 (102.0)	5.96 (152.0)	0.34 (8.7)	1.00 (25.4)
2.50 (63.5)	1.25 (31.8)	3.38 (85.9)	1.75 (44.5)	1.75 (44.5)	0.50 (12.7)	1.38 (35.0)	4.00 (102.0)	5.96 (152.0)	0.34 (8.7)	1.25 (31.6)

NPT Standard Valves (Up to 15,000 PSI / 1034 BAR)

NPT 3-Way, 2 Stems Valves

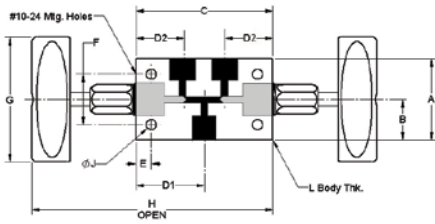

Pressure (PSI)	Connection Type	End Connection Size in.	Part Number	Orifice in. (mm)
15,000	Female NPT	1/4	15NVT3-4NF	0.25 (6.4)
		3/8	15NVT3-6NF	0.312 (7.9)
		1/2	15NVT3-8NF	0.312 (7.9)

Dimensions, in. (mm)

A	B	C	D1	D2	E	F	G	H	J	L
2.00 (50.8)	1.00 (25.4)	3.38 (85.9)	1.69 (42.9)	1.19 (30.2)	0.38 (9.7)	1.24 (31.5)	3.00 (76.2)	9.06 (230.1)	0.25 (6.4)	1.00 (25.4)
2.50 (63.5)	1.25 (31.8)	5.12 (130.0)	2.56 (65.0)	1.75 (44.5)	0.50 (12.7)	1.38 (35.0)	4.00 (102.0)	10.28 (261.1)	0.34 (8.7)	1.00 (25.4)
2.50 (63.5)	1.25 (31.8)	5.12 (130.0)	2.56 (65.0)	1.75 (44.5)	0.50 (12.7)	1.38 (35.0)	4.00 (102.0)	10.28 (261.1)	0.34 (8.7)	1.25 (31.6)

NPT Replaceable Seat Valves

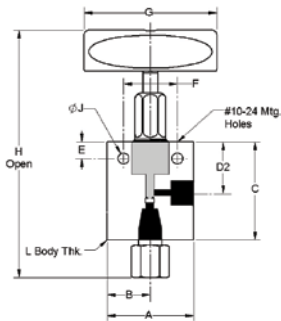

Pressure (PSI)	Connection Type	End Connection Size in.	Part Number	Orifice in. (mm)
15,000	Female NPT	1/4	15NVR4NF	0.25 (6.4)
		3/8	15NVR6NF	0.312 (7.9)
		1/2	15NVR8NF	0.312 (7.9)
10,000		3/4	10NVA12NF	0.44 (11.2)
		1	10NVA16NF	0.562 (14.3)

Dimensions, in. (mm)

A	B	C	D1	D2	E	F	G	H	J	L
2.00 (50.8)	1.00 (25.4)	3.30 (83.8)	-	1.19 (30.2)	0.38 (9.7)	1.24 (31.5)	3.00 (76.2)	6.19 (157.2)	0.25 (6.4)	1.00 (25.4)
2.50 (63.5)	1.25 (31.8)	4.51 (114.6)	-	1.75 (44.5)	0.50 (12.7)	1.38 (35.0)	4.00 (102.0)	7.09 (180.1)	0.34 (8.7)	1.00 (25.4)
2.50 (63.5)	1.25 (31.8)	4.62 (117.3)	-	1.75 (44.5)	0.50 (12.7)	1.38 (35.0)	4.00 (102.0)	7.20 (182.9)	0.34 (8.7)	1.25 (31.6)
3.00 (76.2)	1.5 (38.1)	4.25 (108.0)	-	2.25 (57.2)	0.62 (15.7)	1.76 (44.7)	8.07 (204)	7.56 (192.0)	0.44 (11.2)	1.38 (35.1)
4.12 (105)	2.06 (52.3)	5.13 (130.3)	-	2.82 (71.6)	1.12 (28.4)	2.5 (63.5)	10.29 (261.4)	9.45 (240.0)	0.56 (14.2)	1.75 (44.4)

NPT Quick Open Valves (Up to 15,000 PSI / 1034 BAR)

NPT Quick Open 2-Way Straight Valves

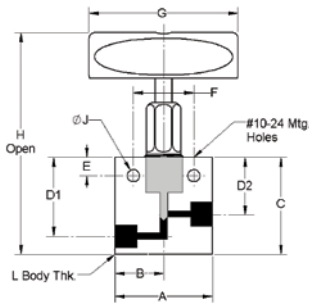

Pressure (PSI)	Connection Type	End Connection Size in.	Part Number	Orifice in. (mm)
15,000	Female NPT	1/4	15NVSQ4NF	0.25 (6.4)
		3/8	15NVSQ6NF	0.312 (7.9)
		1/2	15NVSQ8NF	0.312 (7.9)

Dimensions, in. (mm)

A	B	C	D1	D2	E	F	G	H	J	L
2.00 (50.8)	1.00 (25.4)	2.00 (50.8)	1.63 (41.28)	1.19 (30.2)	0.38 (9.7)	1.24 (31.5)	3.00 (76.2)	4.84 (123.0)	0.25 (6.4)	1.00 (25.4)
2.50 (63.5)	1.25 (31.8)	2.88 (73.2)	2.38 (60.4)	1.75 (44.5)	0.50 (12.7)	1.38 (35.0)	4.00 (102.0)	5.46 (139.0)	0.34 (8.7)	1.00 (25.4)
2.50 (63.5)	1.25 (31.8)	3.00 (76.2)	2.38 (60.4)	1.75 (44.5)	0.50 (12.7)	1.38 (35.0)	4.00 (102.0)	5.58 (142.0)	0.34 (8.7)	1.25 (31.6)

NPT Quick Open 2-Way Angle Valves

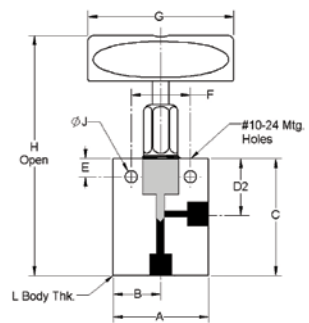

Pressure (PSI)	Connection Type	End Connection Size in.	Part Number	Orifice in. (mm)
15,000	Female NPT	1/4	15NVAQ4NF	0.25 (6.4)
		3/8	15NVAQ6NF	0.312 (7.9)
		1/2	15NVAQ8NF	0.312 (7.9)

Dimensions, in. (mm)

A	B	C	D1	D2	E	F	G	H	J	L
2.00 (50.8)	1.00 (25.4)	2.44 (62.0)	-	1.19 (30.2)	0.38 (9.7)	1.24 (31.5)	3.00 (76.2)	5.28 (134.1)	0.25 (6.4)	1.00 (25.4)
2.50 (63.5)	1.25 (31.8)	3.38 (85.9)	-	1.75 (44.5)	0.50 (12.7)	1.38 (35.0)	4.00 (102.0)	5.96 (152.0)	0.34 (8.7)	1.00 (25.4)
2.50 (63.5)	1.25 (31.8)	3.38 (85.9)	-	1.75 (44.5)	0.50 (12.7)	1.38 (35.0)	4.00 (102.0)	5.96 (152.0)	0.34 (8.7)	1.25 (31.6)

NPT Quick Open 3-Way Valves with 2 Inlets

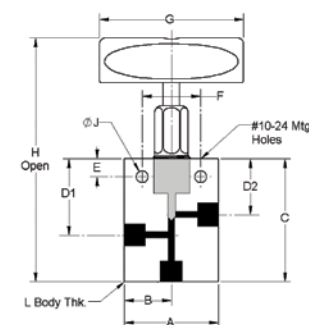

Pressure (PSI)	Connection Type	End Connection Size in.	Part Number	Orifice in. (mm)
15,000	Female NPT	1/4	15NVT2Q4NF	0.25 (6.4)
		3/8	15NVT2Q6NF	0.312 (7.9)
		1/2	15NVT2Q6NF	0.312 (7.9)

Dimensions, in. (mm)

A	B	C	D1	D2	E	F	G	H	J	L
2.00 (50.8)	1.00 (25.4)	2.62 (66.5)	1.63 (41.3)	1.19 (30.2)	0.38 (9.7)	1.24 (31.5)	3.00 (76.2)	5.46 (139.0)	0.25 (6.4)	1.00 (25.4)
2.50 (63.5)	1.25 (31.8)	3.62 (85.9)	2.38 (60.4)	1.75 (44.5)	0.50 (12.7)	1.38 (35.0)	4.00 (102.0)	6.20 (157.5)	0.34 (8.7)	1.00 (25.4)
2.50 (63.5)	1.25 (31.8)	3.62 (85.9)	2.38 (60.4)	1.75 (44.5)	0.50 (12.7)	1.38 (35.0)	4.00 (102.0)	6.20 (157.5)	0.34 (8.7)	1.25 (31.6)

NPT Quick Open Valves (Up to 15,000 PSI / 1034 BAR)

NPT Quick Open 3-Way Valves with 1 Inlet

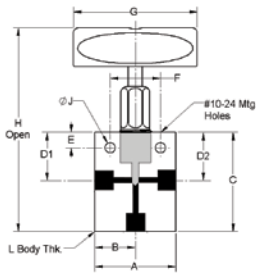

Pressure (PSI)	Connection Type	End Connection Size in.	Part Number	Orifice in. (mm)
15,000	Female NPT	1/4	15NVT1Q4NF	0.25 (6.4)
		3/8	15NVT1Q6NF	0.312 (7.9)
		1/2	15NVT1Q8NF	0.312 (7.9)

Dimensions, in. (mm)

A	B	C	D1	D2	E	F	G	H	J	L
2.00 (50.8)	1.00 (25.4)	2.44 (62.0)	1.19 (30.2)	1.19 (30.2)	0.38 (9.7)	1.24 (31.5)	3.00 (76.2)	5.28 (134.1)	0.25 (6.4)	1.00 (25.4)
2.50 (63.5)	1.25 (31.8)	3.38 (85.9)	1.75 (44.5)	1.75 (44.5)	0.50 (12.7)	1.38 (35.0)	4.00 (102.0)	5.96 (152.0)	0.34 (8.7)	1.00 (25.4)
2.50 (63.5)	1.25 (31.8)	3.38 (85.9)	1.75 (44.5)	1.75 (44.5)	0.50 (12.7)	1.38 (35.0)	4.00 (102.0)	5.96 (152.0)	0.34 (8.7)	1.25 (31.6)

NPT Quick Open 3-Way, 2 Stems Valves

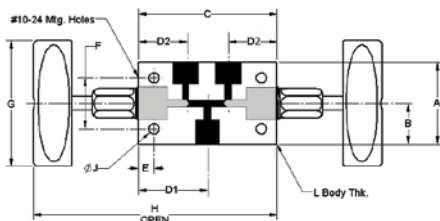

Pressure (PSI)	Connection Type	End Connection Size in.	Part Number	Orifice in. (mm)
15,000	Female NPT	1/4	15NVT3Q4NF	0.25 (6.4)
		3/8	15NVT3Q6NF	0.312 (7.9)
		1/2	15NVT3Q8NF	0.312 (7.9)

Dimensions, in. (mm)

A	B	C	D1	D2	E	F	G	H	J	L
2.00 (50.8)	1.00 (25.4)	3.38 (85.9)	1.69 (42.9)	1.19 (30.2)	0.38 (9.7)	1.24 (31.5)	3.00 (76.2)	9.06 (230.1)	0.25 (6.4)	1.00 (25.4)
2.50 (63.5)	1.25 (31.8)	5.12 (130.0)	2.56 (65.0)	1.75 (44.5)	0.50 (12.7)	1.38 (35.0)	4.00 (102.0)	10.28 (261.1)	0.34 (8.7)	1.00 (25.4)
2.50 (63.5)	1.25 (31.8)	5.12 (130.0)	2.56 (65.0)	1.75 (44.5)	0.50 (12.7)	1.38 (35.0)	4.00 (102.0)	10.28 (261.1)	0.34 (8.7)	1.25 (31.6)

NPT Quick Open Replaceable Seat Valves

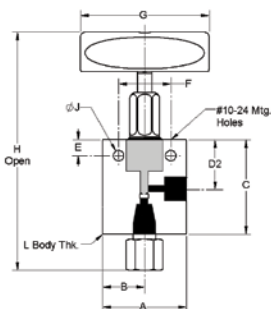

Pressure (PSI)	Connection Type	End Connection Size in.	Part Number	Orifice in. (mm)
15,000	Female NPT	1/4	15NVRQ4NF	0.25 (6.4)
		3/8	15NVRQ6NF	0.312 (7.9)
		1/2	15NVRQ8NF	0.312 (7.9)

Dimensions, in. (mm)

A	B	C	D1	D2	E	F	G	H	J	L
2.00 (50.8)	1.00 (25.4)	3.30 (83.8)	-	1.19 (30.2)	0.38 (9.7)	1.24 (31.5)	3.00 (76.2)	6.19 (157.2)	0.25 (6.4)	1.00 (25.4)
2.50 (63.5)	1.25 (31.8)	4.51 (114.6)	-	1.75 (44.5)	0.50 (12.7)	1.38 (35.0)	4.00 (102.0)	7.09 (180.1)	0.34 (8.7)	1.00 (25.4)
2.50 (63.5)	1.25 (31.8)	4.62 (117.3)	-	1.75 (44.5)	0.50 (12.7)	1.38 (35.0)	4.00 (102.0)	7.20 (182.9)	0.34 (8.7)	1.25 (31.6)

NPT Fittings (Up to 15,000 PSI / 1034 BAR)

NPT Female Tees

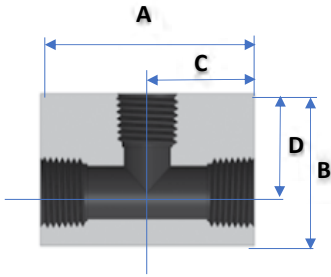

Part Number	Pressure (PSI)	Connections	A (in.)	B (in.)	C (in.)	D (in.)	Thickness (in.)
15T2NF	15,000	1/8" NPT.F	1.50	1.00	0.75	0.62	0.62
15T4NF	15,000	1/4" NPT.F	2.00	1.25	1.00	0.81	0.75
15T6NF	15,000	3/8" NPT.F	2.00	1.50	1.00	1.00	1.00
15T8NF	15,000	1/2" NPT.F	2.50	1.75	1.25	1.25	1.25
10T12NF	10,000	3/4" NPT.F	2.62	2.12	1.31	1.38	1.50
10T16NF	10,000	1" NPT.F	3.38	2.56	1.69	1.69	1.75

NPT Male Tees

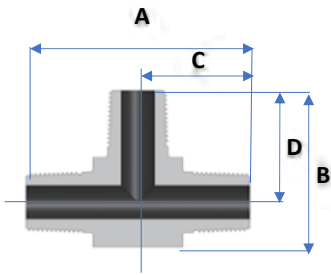

Part Number	Pressure (PSI)	Connections	A (in.)	B (in.)	C (in.)	D (in.)	Thickness (in.)
15T2NM	15,000	1/8" NPT.M	1.50	1.13	0.75	0.81	0.62
15T4NM	15,000	1/4" NPT.M	2.25	1.50	1.13	1.13	0.75
15T6NM	15,000	3/8" NPT.M	2.50	1.75	1.25	1.25	1.00
15T8NM	15,000	1/2" NPT.M	3.00	2.00	1.50	1.50	1.00
10T1NM	10,000	3/4" NPT.M	3.50	2.62	1.75	1.75	1.50
10T16NM	10,000	1" NPT.M	4.25	3.00	2.13	2.13	1.75

NPT Run Tees

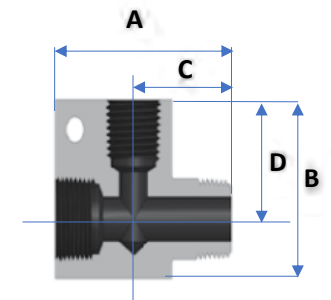

Part Number	Pressure (PSI)	Connections	A (in.)	B (in.)	C (in.)	D (in.)	Thickness (in.)
15RT2NF2NM2NF	15,000	1/8" NPT.F x 1/8" NPT.M x 1/8" NPT.F	1.50	1.12	0.63	0.75	0.62
15RT4NF4NM4NF	15,000	1/4" NPT.F x 1/4" NPT.M x 1/4" NPT.F	2.00	1.37	0.81	1.00	0.75
15RT6NF6NM6NF	15,000	3/8" NPT.F x 3/8" NPT.M x 3/8" NPT.F	2.50	1.50	1.00	1.00	1.00
15RT8NF8NM8NF	15,000	1/2" NPT.F x 1/2" NPT.M x 1/2" NPT.F	2.75	1.75	1.25	1.25	1.38
10RT12NF12NM12NF	10,000	3/4" NPT.F x 3/4" NPT.M x 3/4" NPT.F	3.12	2.62	1.31	1.31	1.50
10RT16NF16NM16NF	10,000	1" NPT.F x 1" NPT.M x 1" NPT.F	4.25	3.00	2.13	2.13	1.75

NPT Branch Tees

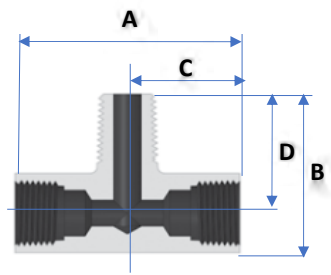

Part Number	Pressure (PSI)	Connections	A (in.)	B (in.)	C (in.)	D (in.)	Thickness (in.)
15BT2NF2NF2NM	15,000	1/8" NPT.F x 1/8" NPT.F x 1/8" NPT.M	1.50	1.13	0.75	0.81	0.62
15BT4NF4NF4NM	15,000	1/4" NPT.F x 1/4" NPT.F x 1/4" NPT.M	2.00	1.50	1.00	1.13	0.75
15BT6NF6NF6NM	15,000	3/8" NPT.F x 3/8" NPT.F x 3/8" NPT.M	2.00	1.75	1.00	1.25	1.00
15BT8NF8NF8NM	15,000	1/2" NPT.F x 1/2" NPT.F x 1/2" NPT.M	2.50	2.25	1.25	1.63	1.25
10BT12NF12NF12NM	10,000	3/4" NPT.F x 3/4" NPT.F x 3/4" NPT.M	2.62	2.50	1.31	1.75	1.50
10BT16NF16NF16NM	10,000	1" NPT.F x 1" NPT.F x 1" NPT.M	3.37	3.00	1.69	2.13	1.75

NPT Fittings (Up to 15,000 PSI / 1034 BAR)

NPT Crosses

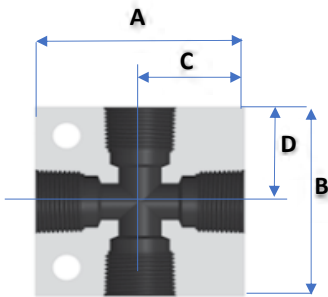

Part Number	Pressure (PSI)	Connections	A (in.)	B (in.)	C (in.)	D (in.)	Thickness (in.)
15X2NF	15,000	1/8" NPT.F	1.50	1.50	0.75	0.75	0.62
15X4NF	15,000	1/4" NPT.F	2.00	2.00	1.00	1.00	0.75
15X6NF	15,000	3/8" NPT.F	2.00	2.00	1.00	1.00	1.00
15X8NF	15,000	1/2" NPT.F	2.50	2.50	1.25	1.25	1.25
10X12NF	10,000	3/4" NPT.F	2.70	2.70	1.31	1.31	1.50
10X16NF	10,000	1" NPT.F	4.12	4.12	2.06	2.06	1.75

NPT Female Elbows

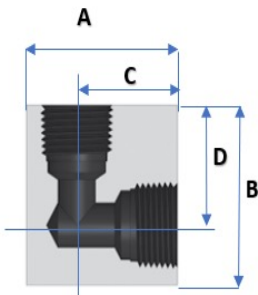

Part Number	Pressure (PSI)	Connections	A (in.)	B (in.)	C (in.)	D (in.)	Thickness (in.)
15L2NF	15,000	1/8" NPT.M x 1/8" NPT.M	1.13	1.00	0.75	0.62	0.62
15L4NF	15,000	1/4" NPT.M x 1/4" NPT.M	1.50	1.25	1.00	0.81	0.75
15L6NF	15,000	3/8" NPT.M x 3/8" NPT.M	1.50	1.50	1.00	1.00	1.00
15L8NF	15,000	1/2" NPT.M x 1/2" NPT.M	1.75	1.75	1.25	1.25	1.25
10L12NF	10,000	3/4" NPT.M x 3/4" NPT.M	2.62	2.12	1.31	1.38	1.50
10L16NF	10,000	1" NPT.M x 1" NPT.M	3.00	2.56	1.69	1.69	1.75

NPT Male Elbows

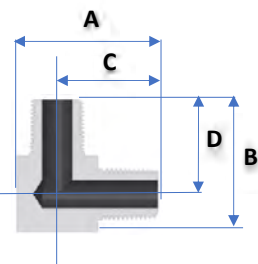

Part Number	Pressure (PSI)	Connections	A (in.)	B (in.)	C (in.)	D (in.)	Thickness (in.)
15L2NM	15,000	1/8" NPT.M x 1/8" NPT.M	1.00	1.13	0.75	0.81	0.62
15L4NM	15,000	1/4" NPT.M x 1/4" NPT.M	1.50	1.50	1.13	1.13	0.75
15L6NM	15,000	3/8" NPT.M x 3/8" NPT.M	1.75	1.75	1.25	1.25	1.00
15L8NM	15,000	1/2" NPT.M x 1/2" NPT.M	2.00	2.00	1.50	1.50	1.00
10L12NM	10,000	3/4" NPT.M x 3/4" NPT.M	2.62	2.62	1.75	1.75	1.50
10L16NM	10,000	1" NPT.M x 1" NPT.M	3.00	3.00	2.13	2.13	1.75

NPT Street Elbows

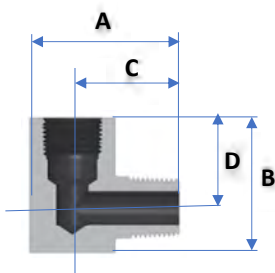

Part Number	Pressure (PSI)	Connections	A (in.)	B (in.)	C (in.)	D (in.)	Thickness (in.)
15SL2NF2NM	15,000	1/8" NPT.F x 1/8" NPT.M	1.12	1.00	0.81	0.75	0.62
15SL4NF4NM	15,000	1/4" NPT.F x 1/4" NPT.M	1.50	1.50	1.13	1.00	1.00
15SL6NF6NM	15,000	3/8" NPT.F x 3/8" NPT.M	1.75	1.50	1.25	1.00	1.00
15SL8NF8NM	15,000	1/2" NPT.F x 1/2" NPT.M	2.25	2.00	1.63	1.20	1.25
10SL12NF12NM	10,000	3/4" NPT.F x 3/4" NPT.M	2.50	2.62	1.75	1.31	1.50
10SL16NF16NM	10,000	1" NPT.F x 1" NPT.M	3.00	2.88	2.12	1.68	1.75

NPT Fittings (Up to 15,000 PSI / 1034 BAR)

NPT Bulkhead Couplings

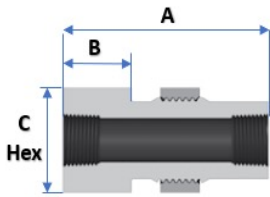

Part Number	Pressure (PSI)	Connections	A (in.)	B (in.)	Panel Cutout (in.)
15BU2NF	15,000	1/8" NPT.F	2.00	1.00	0.81
15BU4NF	15,000	1/4" NPT.F	2.00	1.00	0.94
15BU6NF	15,000	3/8" NPT.F	2.62	1.38	1.25
15BU8NF	15,000	1/2" NPT.F	2.62	1.88	1.37
10BU12NF	10,000	3/4" NPT.F	2.62	1.88	1.69
10BU16NF	10,000	1" NPT.F	3.50	2.13	1.94

NPT Bulkhead Couplings c/w Welded Plates

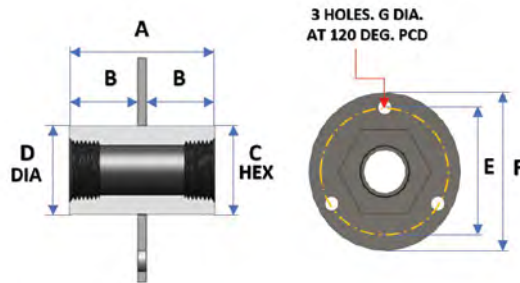

Part Number	Pressure (PSI)	Connections	A (in.)	B (in.)	C (in.)	D (in.)	E (in.)	F (in.)	G (in.)	Panel Cutout (in.)
15BU2NF-RW	15,000	1/8" NPT.F	1.00	0.44	0.63	0.59	2.05	2.52	0.24	0.63
15BU4NF-RW	15,000	1/4" NPT.F	1.25	0.57	0.75	0.71	2.05	2.52	0.24	0.75
15BU6NF-RW	15,000	3/8" NPT.F	1.38	0.63	1.00	0.94	2.05	2.52	0.24	0.98
15BU8NF-RW	15,000	1/2" NPT.F	1.50	0.69	1.38	1.34	2.05	2.52	0.24	1.38
10BU12NF-RW	10,000	3/4" NPT.F	1.75	0.82	1.38	1.34	2.05	2.52	0.24	1.38
10BU16NF-RW	10,000	1" NPT.F	2.18	1.03	1.75	1.69	2.24	2.76	0.28	1.73

NPT Fittings (Up to 15,000 PSI / 1034 BAR)

Couplings

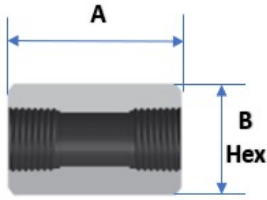

Part Number	Pressure (PSI)	Connections	A (in.)	B (in.)
15CU2NF	15,000	1/8" NPT.F	1.00	0.63
15CU4NF	15,000	1/4" NPT.F	1.25	0.75
15CU6NF	15,000	3/8" NPT.F	1.38	1.00
15CU8NF	15,000	1/2" NPT.F	1.5	1.38
10CU12NF	10,000	3/4" NPT.F	1.75	1.38
10CU16NF	10,000	1" NPT.F	2.18	1.75

Caps

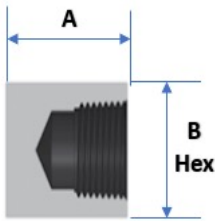

Part Number	Pressure (PSI)	Connections	A (in.)	B (in.)
15CA2NF	15,000	1/8" NPT.F	0.75	0.63
15CA4NF	15,000	1/4" NPT.F	1.00	0.75
15CA6NF	15,000	3/8" NPT.F	1.00	1.00
15CA8NF	15,000	1/2" NPT.F	1.25	1.38
10CA12NF	10,000	3/4" NPT.F	1.50	1.38
10CA16NF	10,000	1" NPT.F	1.68	1.75

Plugs

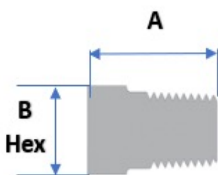

Part Number	Pressure (PSI)	Connections	A (in.)	B (in.)
15PL2NM	15,000	1/8" NPT.M	1.00	0.50
15PL4NM	15,000	1/4" NPT.M	1.12	0.63
15PL6NM	15,000	3/8" NPT.M	1.12	0.75
15PL8NM	15,000	1/2" NPT.M	1.50	1.00
10PL12NM	10,000	3/4" NPT.M	1.50	1.38
10PL16NM	10,000	1" NPT.M	1.88	1.38

NPT Check Valves (Up to 15,000 PSI / 1034 BAR)

NPT Ball Check Valves

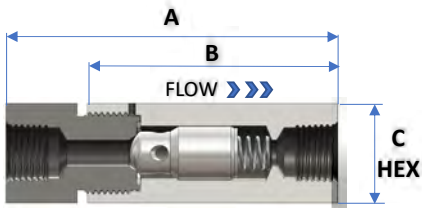

Part Number	Pressure (PSI)	Orifice (in.)	Connections	A (in.)	B (in.)	C (in.)
15BCV4NF	15,000	0.188	1/4" FNPT	3.20	2.50	1.00
15BCV6NF	15,000	0.219	3/8" FNPT	3.56	2.66	1.13
15BCV8NF	15,000	0.359	1/2" FNPT	4.63	3.50	1.38
10BCV12NF	10,000	0.516	3/4" FNPT	5.63	4.38	1.75
10BCV16NF	10,000	0.588	1" FNPT	7.00	5.25	2.13

NPT Soft Seat Check Valves

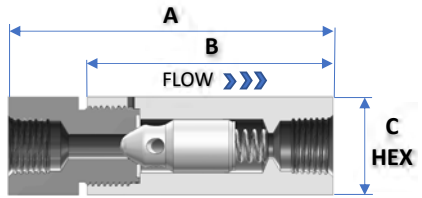

Part Number	Pressure (PSI)	Orifice (in.)	Connections	A (in.)	B (in.)	C (in.)
15SCV4NF	15,000	0.188	1/4" FNPT	3.20	2.50	1.00
15SCV6NF	15,000	0.219	3/8" FNPT	3.56	2.66	1.13
15SCV8NF	15,000	0.359	1/2" FNPT	4.63	3.50	1.38
10SCV12NF	10,000	0.516	3/4" FNPT	5.63	4.38	1.75
10SCV16NF	10,000	0.588	1" FNPT	7.00	5.25	2.13

NPT In-Line Filters (Up to 15,000 PSI / 1034 BAR)

NPT In-Line Filters

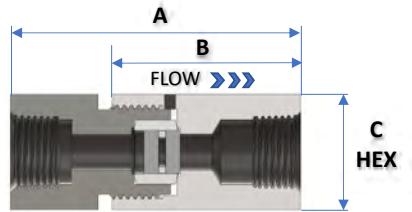

Part Number	Pressure (PSI)	Connections	Orifice (in.)	A (in.)	B (in.)	C (in.)	Micron Size Filter Available					
							0.5	2	5	10	40	100
15LF4NF-*	15,000	1/4" NPT.F	0.188	2.13	1.50	1.00	●	●	●	●	●	●
15LF6NF-*	15,000	3/8" NPT.F	0.219	2.50	1.63	1.13	●	●	●	●	●	●
15LF8NF-*	15,000	1/2" NPT.F	0.359	3.25	2.06	1.38	●	●	●	●	●	●
15LF12NF-*	10,000	3/4" NPT.F	0.516	4.06	2.88	1.75	●	●	●	●	●	●
15LF16NF-*	10,000	1" NPT.F	0.588	5.00	3.30	2.13	●	●	●	●	●	●

* Insert desired micron filter
 Example: 15LF4NF-5 is a 1/4"NPT In-Line filter with 5 micron filter

NPT Cup Filters

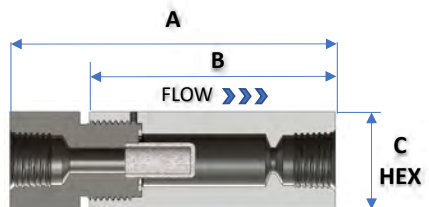

Part Number	Pressure (PSI)	Connections	Orifice (in.)	A (in.)	B (in.)	C (in.)	Micron Size Filter Available					
							0.5	2	5	10	40	100
15CF4NF-*	15,000	1/4" NPT.F	0.188	3.20	2.50	1.00	●	●	●	●	●	●
15CF6NF-*	15,000	3/8" NPT.F	0.219	3.56	2.66	1.13	●	●	●	●	●	●
15CF8NF-*	15,000	1/2" NPT.F	0.359	4.63	3.50	1.38	●	●	●	●	●	●
15CF12NF-*	10,000	3/4" NPT.F	0.516	5.63	4.38	1.75	●	●	●	●	●	●
15CF16NF-*	10,000	1" NPT.F	0.588	7.00	5.25	2.13	●	●	●	●	●	●

* Insert desired micron filter
 Example: 15CF4NF-5 is a 1/4"NPT Cup filter with 5 micron filter